

# 829+804

mm.91,8x17,7

Cerniere invisibili regolabili per porte  
Invisible adjustable hinges for doors  
Bisagras invisibles ajustables para puertas

Cod. CI829804 **NIK00**  
Cod. CI829804 **OTT00**  
Cod. CI829804 **BRO00**

 Pack. 20

**CARATTERISTICHE:**

- Realizzata in zama in 3 diverse finiture
- Adatta per ante con spessore minimo di 24 mm
- Lunghezza totale solo 92 mm
- Profondità solo 25 mm
- Regolazione bidimensionale (verticale e profondità)
- Portata fino a 25 kg
- Easy installation e simmetria di cava

**MAIN FEATURES:**

- Produced in zamak in 3 different finishes
- Suitable for doors of 24 mm min. thickness
- Total length 92 mm
- Depth 25 mm
- 2D (vertical and depth) adjusting system
- Load capacity up to 25 kg
- Easy installation and slot symmetry

**CARACTERÍSTICAS:**

- Fabricada en zamak en 3 acabados diferentes
- Adapta para puertas con un espesor mínimo de 24 mm
- Longitud total 92 mm
- Profundidad de 25 mm
- Ajuste en 2D (vertical y profundidad)
- Capacidad de carga hasta 25 kg
- Easy installation y simetría de corte

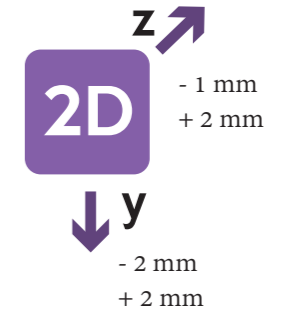
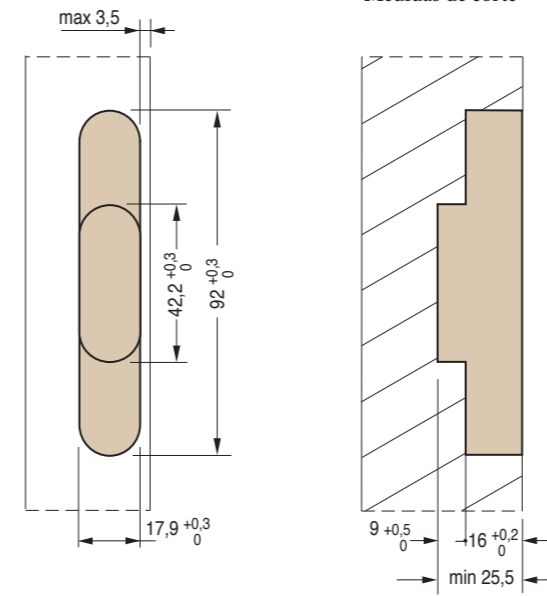

**REVERSIBILITÀ - REVERSIBILITY - REVERSIBILIDAD**

Reversibile per porte da 24 mm a 25 mm di spessore  
Reversible for doors from 24 mm to 25 mm thick  
Reversible para puertas de 24 mm hasta 25 mm de espesor

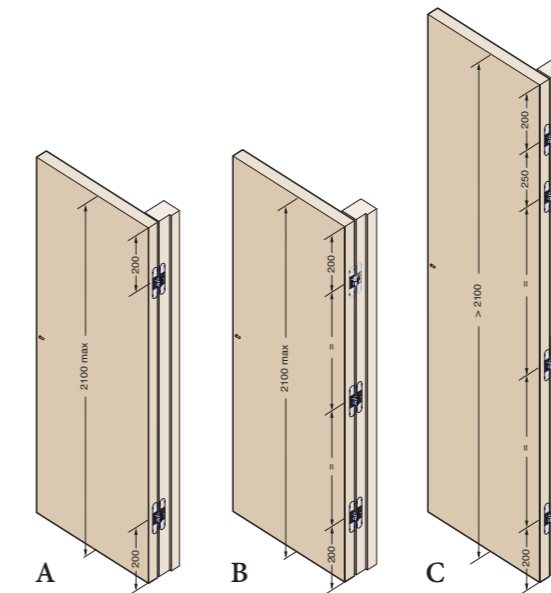
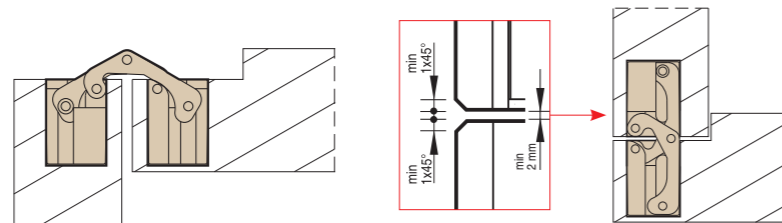
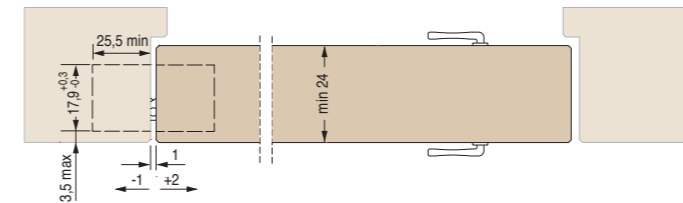
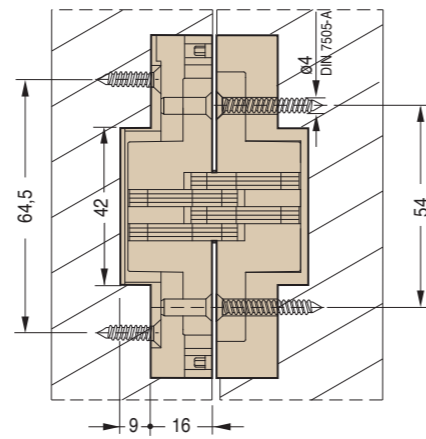
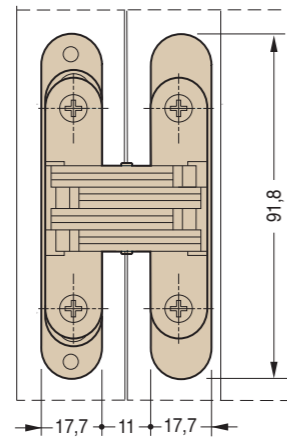
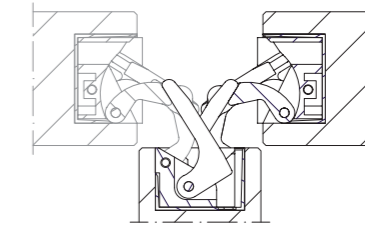

**PORTATA ANTE**

Larghe fino a 850 mm  
Alte fino a 2100 mm  
A - 2 cerniere kg 15  
B - 3 cerniere kg 25  
Alte oltre 2100 mm  
C - 4 cerniere kg 25

**CAPACITY DOORS**

Width up to 850 mm  
Alte fino a 2100 mm  
A - 2 hinges kg 15  
B - 3 hinges kg 25  
More than 2100 mm high  
C - 4 hinges kg 25

**CAPACIDAD PUERTAS**

Anchas hasta 850 mm  
Altas hasta 2100 mm  
A - 2 bisagras kg 15  
B - 3 bisagras kg 25  
Mas altas que 2100 mm  
C - 4 bisagras kg 25



**Basetta regolabile**  
Adjustable base  
Base ajustable



**Montaggio**  
Mounting  
Montaje

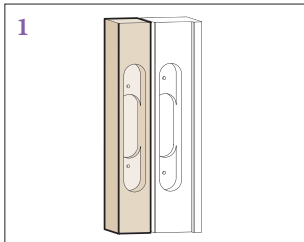

Esecuzione delle cave nella porta e nello stipite.

Implementation of hollow spaces both in the door and in the post.

Ejecución de cortes en el marco y en la hoja de la puerta.

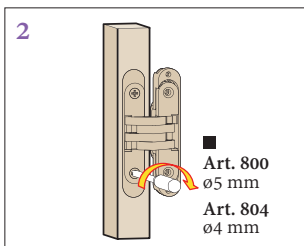

Montaggio della basetta fissa e della cerniera nella porta;  
vite autofilettante testa svasata piana. ■

Mounting of a fixed base and door hinge;  
flat countersunk-head self-tapping screw. ■

Montaje de la base fija y de la bisagra en la puerta;  
tornillo autorroscante de cabeza avellanada. ■

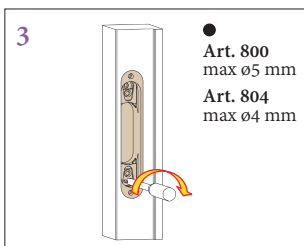

Montaggio della basetta regolabile nello stipite;  
**Importante:** vite autofilettante testa svasata piana. ●

Mounting of adjustable base on the post;  
**Attention:** flat countersunk-head self-tapping screw. ●

Montaje de la base ajustable en el marco;  
**Importante:** tornillo autorroscante de cabeza avellanada. ●

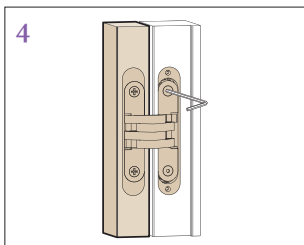

Montaggio cerniera nello stipite; vite testa svasata, brugola inserite nel kit.

Mounting of hinge on the post:  
countersunk-head screw, Allen screw included in the kit.

Montaje de la bisagra en el marco;  
tornillos avellanados, llave de montaje incluidos en el kit.

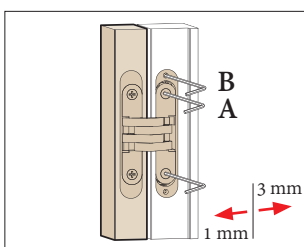

- Allentare A
- Regolare B
- Serrare A
- Loosen A
- Adjust B
- Tighten A
- Aflojar A
- Ajustar B
- Aprietar A

Regolazione in profondità  
Depth adjustment  
Ajuste de profundidad

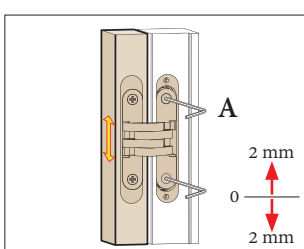

- Allentare A
- Regolare la porta
- Serrare A
- Loosen A
- Adjust the door
- Tighten A
- Aflojar A
- Ajustar la puerta
- Aprietar A

Regolazione verticale  
Vertical adjustment  
Ajuste vertical

