

830+800
mm.121,9x21,7

Cerniere invisibili regolabili per porte
Invisible adjustable hinges for doors
Bisagras invisibles ajustables para puertas

Cod. CI830800 NIK00
Cod. CI830800 OTT00
Cod. CI830800 BRO00

Pack. 20

CARATTERISTICHE:

- Realizzata in zama in 3 diverse finiture
- Adatta per ante con spessore minimo di 28 mm
- Lunghezza totale 122 mm
- Profondità solo 30 mm
- Regolazione bidimensionale (verticale e profondità)
- Portata fino a 50 kg
- Easy installation e simmetria di cava

MAIN FEATURES:

- Produced in zamak in 3 different finishes
- Suitable for doors of 28 mm min. thickness
- Total length 122 mm
- Depth 30 mm
- 2D (vertical and depth) adjusting system
- Load capacity up to 50 kg
- Easy installation and slot symmetry

CARACTERÍSTICAS:

- Fabricada en zamak en 3 acabados diferentes
- Adapta para puertas con un espesor mínimo de 28 mm
- Longitud total 122 mm
- Profundidad de 30 mm
- Ajuste en 2D (vertical y profundidad)
- Capacidad de carga hasta 50 kg
- Easy installation y simetría de corte

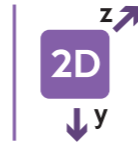

Misure della cava
Slot measurement
Medidas de corte

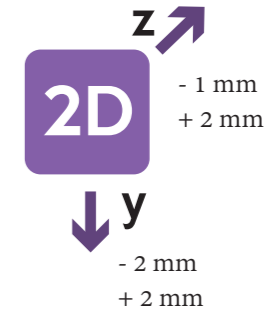
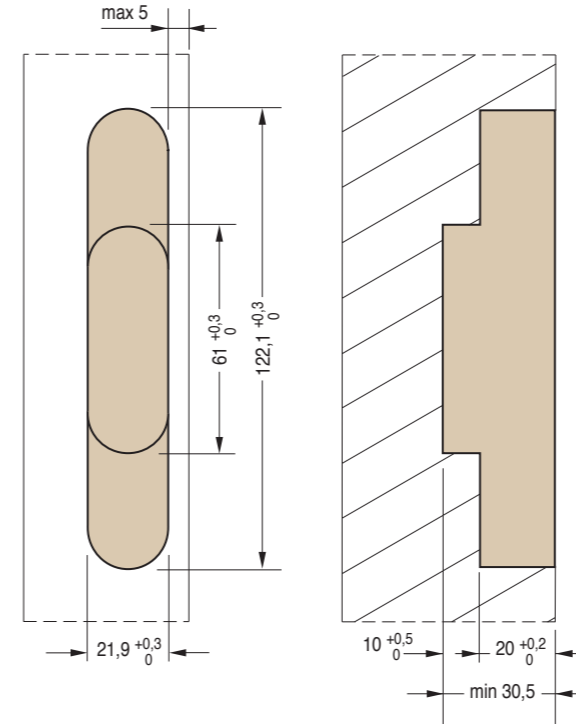

REVERSIBILITÀ - REVERSIBILITY - REVERSIBILIDAD

Reversibile per porte da 28 mm a 32 mm di spessore
Reversible for doors from 28 mm to 32 mm thick
Reversible para puertas de 28 mm hasta 32 mm de espesor

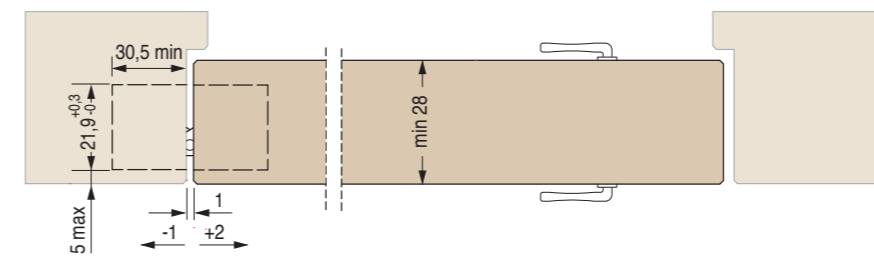
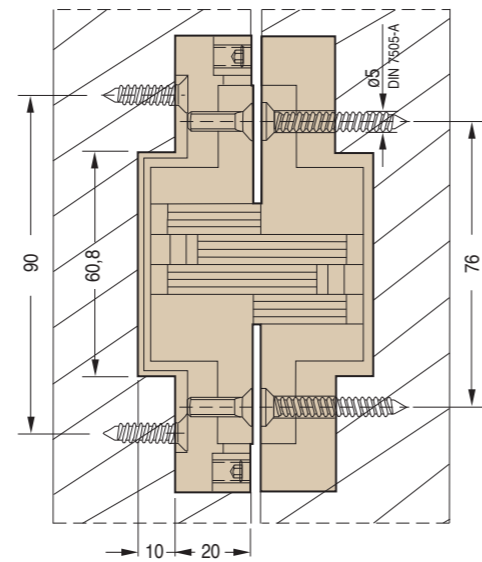
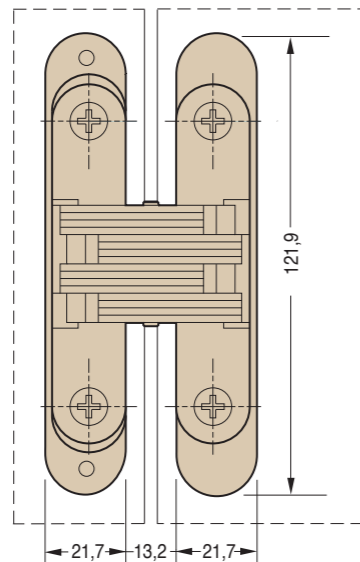
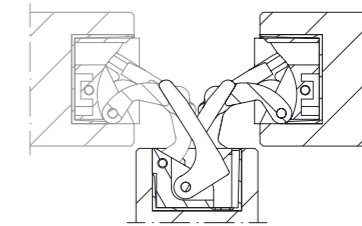

Sezione porta
Door cross-section
Sección de puerta

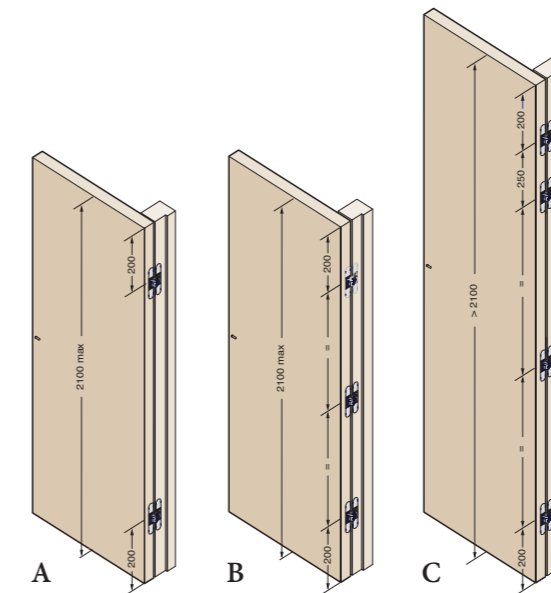
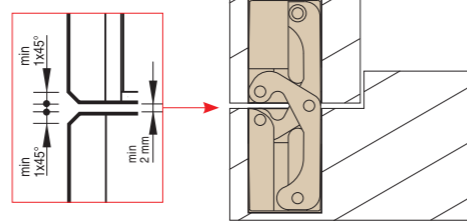
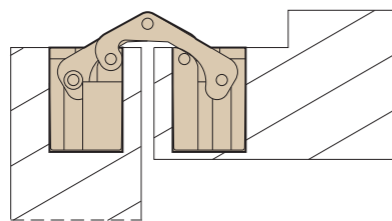

PORTATA ANTE

Larghe fino a 850 mm
Alte fino a 2100 mm
A - 2 cerniere kg 35
B - 3 cerniere kg 50
Alte oltre 2100 mm
C - 4 cerniere kg 50

CAPACITY DOORS

Width up to 850 mm
Alte fino a 2100 mm
A - 2 hinges kg 35
B - 3 hinges kg 50
More than 2100 mm high
C - 4 hinges kg 50

CAPACIDAD PUERTAS

Anchas hasta 850 mm
Altas hasta 2100 mm
A - 2 bisagras kg 35
B - 3 bisagras kg 50
Mas altas que 2100 mm
C - 4 bisagras kg 50



Basetta regolabile
Adjustable base
Base ajustable



Montaggio
Mounting
Montaje

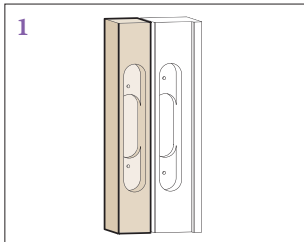

Esecuzione delle cave nella porta e nello stipite.

Implementation of hollow spaces both in the door and in the post.

Ejecución de cortes en el marco y en la hoja de la puerta.

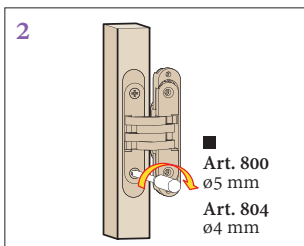

Montaggio della basetta fissa e della cerniera nella porta;
vite autofilettante testa svasata piana. ■

Mounting of a fixed base and door hinge;
flat countersunk-head self-tapping screw. ■

Montaje de la base fija y de la bisagra en la puerta;
tornillo autorroscante de cabeza avellanada. ■

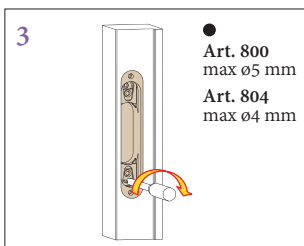

Montaggio della basetta regolabile nello stipite;
Importante: vite autofilettante testa svasata piana. ●

Mounting of adjustable base on the post;
Attention: flat countersunk-head self-tapping screw. ●

Montaje de la base ajustable en el marco;
Importante: tornillo autorroscante de cabeza avellanada. ●

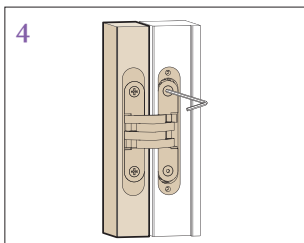

Montaggio cerniera nello stipite; vite testa svasata, brugola inserite nel kit.

Mounting of hinge on the post:
countersunk-head screw, Allen screw included in the kit.

Montaje de la bisagra en el marco;
tornillos avellanados, llave de montaje incluidos en el kit.

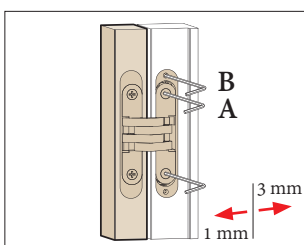

- Allentare A
- Regolare B
- Serrare A
- Loosen A
- Adjust B
- Tighten A
- Aflojar A
- Ajustar B
- Aprietar A

Regolazione in profondità
Depth adjustment
Ajuste de profundidad

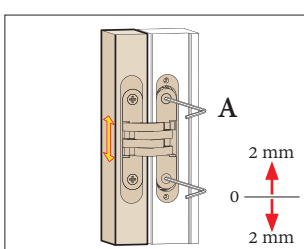

- Allentare A
- Regolare la porta
- Serrare A
- Loosen A
- Adjust the door
- Tighten A
- Aflojar A
- Ajustar la puerta
- Aprietar A

Regolazione verticale
Vertical adjustment
Ajuste vertical

