

**930+800**  
mm.121,9x21,7

Cerniere invisibili regolabili per porte  
Invisible adjustable hinges for doors  
Bisagras invisibles ajustables para puertas

Cod. CI930800 NIK00  
Cod. CI930800 OTT00  
Cod. CI930800 NOP00

 Pack. 20

**CARATTERISTICHE:**

- Realizzata in zama in 3 diverse finiture
- Adatta per ante con spessore minimo di 28 mm
- Lunghezza totale 122 mm
- Profondità solo 30 mm
- Regolazione bidimensionale (verticale e profondità)
- Portata fino a 60 kg
- Easy installation e simmetria di cava

**MAIN FEATURES:**

- Produced in zamak in 3 different finishes
- Suitable for doors of 28 mm min. thickness
- Total length 122 mm
- Depth 30 mm
- 2D (vertical and depth) adjusting system
- Load capacity up to 60 kg
- Easy installation and slot symmetry

**CARACTERÍSTICAS:**

- Fabricada en zamak en 3 acabados diferentes
- Adapta para puertas con un espesor mínimo de 28 mm
- Longitud total 122 mm
- Profundidad de 30 mm
- Ajuste en 2D (vertical y profundidad)
- Capacidad de carga hasta 60 kg
- Easy installation y simetría de corte

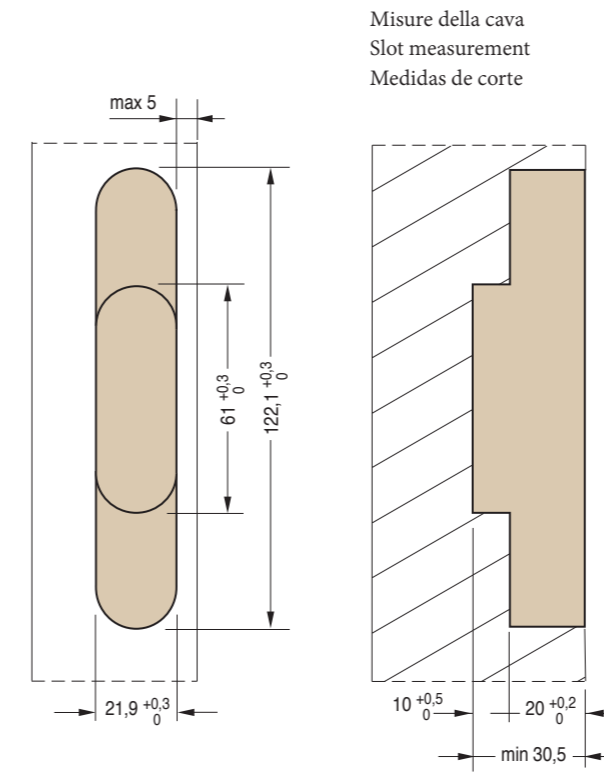

Misure della cava  
Slot measurement  
Medidas de corte

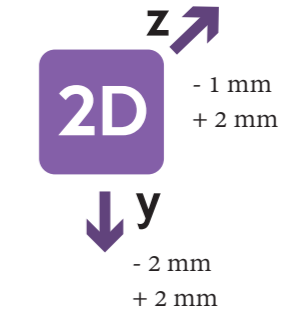

**REVERSIBILITÀ - REVERSIBILITY - REVERSIBILIDAD**

Reversibile per porte da 28 mm a 32 mm di spessore  
Reversible for doors from 28 mm to 32 mm thick  
Reversible para puertas de 28 mm hasta 32 mm de espesor

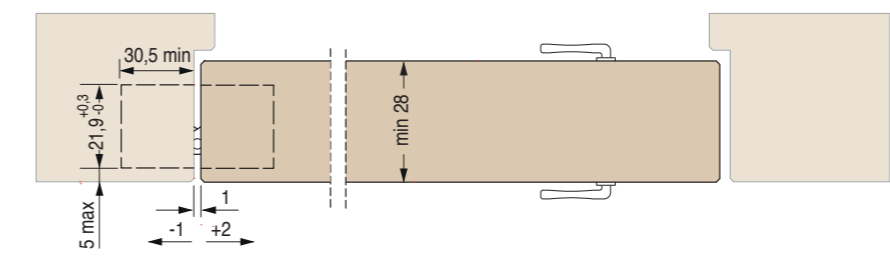
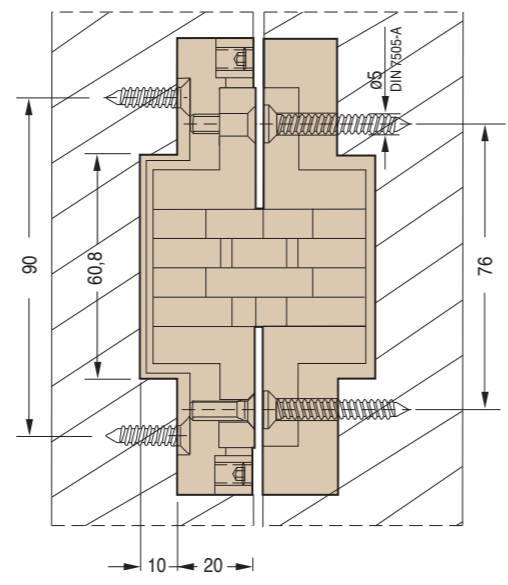
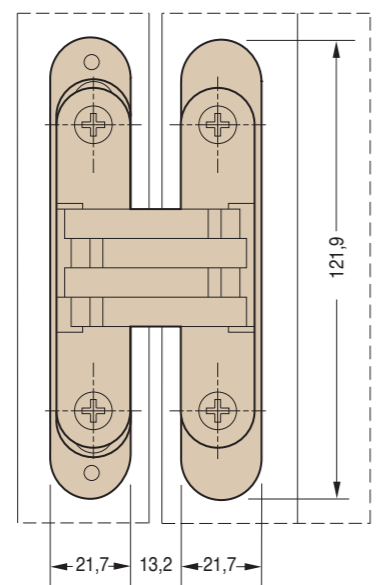
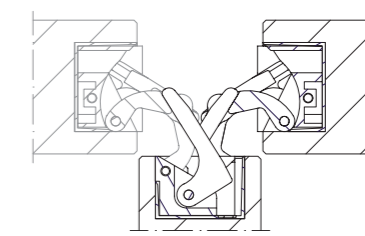

Sezione porta  
Door cross-section  
Sección de puerta

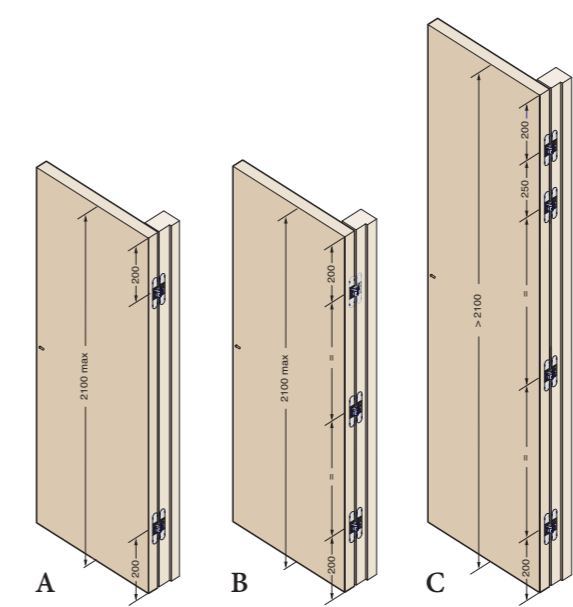
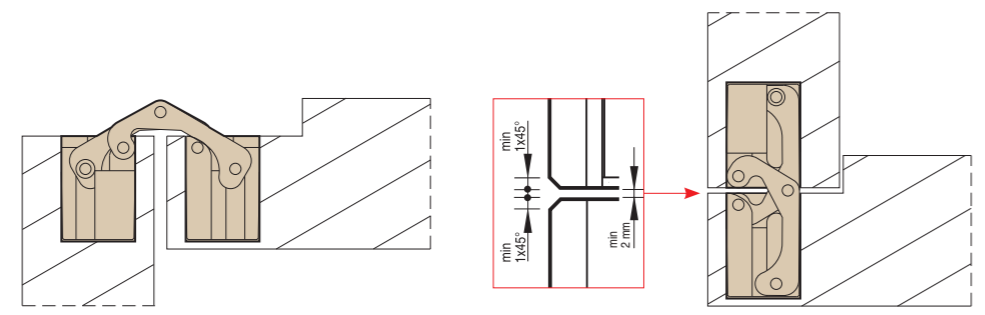

**PORTATA ANTE**  
Larghe fino a 850 mm  
Alte fino a 2100 mm  
A - 2 cerniere kg 40  
B - 3 cerniere kg 60  
Alte oltre 2100 mm  
C - 4 cerniere kg 60

**CAPACITY DOORS**  
Width up to 850 mm  
Alte fino a 2100 mm  
A - 2 hinges kg 40  
B - 3 hinges kg 60  
More than 2100 mm high  
C - 4 hinges kg 60

**CAPACIDAD PUERTAS**  
Anchas hasta 850 mm  
Altas hasta 2100 mm  
A - 2 bisagras kg 40  
B - 3 bisagras kg 60  
Mas altas que 2100 mm  
C - 4 bisagras kg 60

**Basetta regolabile**  
Adjustable base  
Base ajustable



**Montaggio**  
Mounting  
Montaje

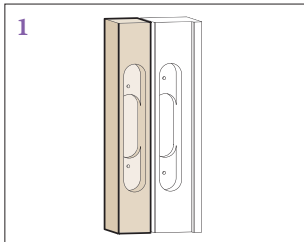

Esecuzione delle cave nella porta e nello stipite.

Implementation of hollow spaces both in the door and in the post.

Ejecución de cortes en el marco y en la hoja de la puerta.

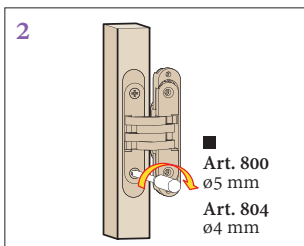

Montaggio della basetta fissa e della cerniera nella porta;  
vite autofilettante testa svasata piana. ■

Mounting of a fixed base and door hinge;  
flat countersunk-head self-tapping screw. ■

Montaje de la base fija y de la bisagra en la puerta;  
tornillo autorroscante de cabeza avellanada. ■

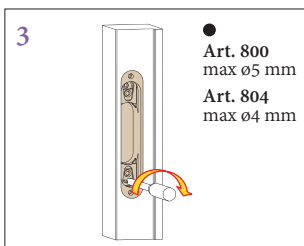

Montaggio della basetta regolabile nello stipite;  
**Importante:** vite autofilettante testa svasata piana. ●

Mounting of adjustable base on the post;  
**Attention:** flat countersunk-head self-tapping screw. ●

Montaje de la base ajustable en el marco;  
**Importante:** tornillo autorroscante de cabeza avellanada. ●

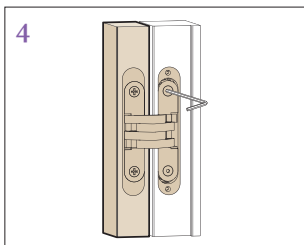

Montaggio cerniera nello stipite; vite testa svasata, brugola inserite nel kit.

Mounting of hinge on the post:  
countersunk-head screw, Allen screw included in the kit.

Montaje de la bisagra en el marco;  
tornillos avellanados, llave de montaje incluidos en el kit.

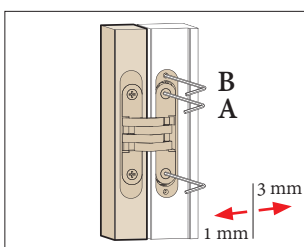

- Allentare A
- Regolare B
- Serrare A
- Loosen A
- Adjust B
- Tighten A
- Aflojar A
- Ajustar B
- Aprietar A

Regolazione in profondità  
Depth adjustment  
Ajuste de profundidad

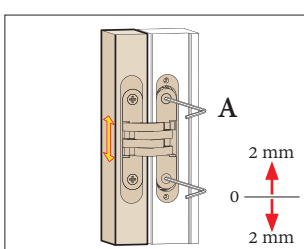

- Allentare A
- Regolare la porta
- Serrare A
- Loosen A
- Adjust the door
- Tighten A
- Aflojar A
- Ajustar la puerta
- Aprietar A

Regolazione verticale  
Vertical adjustment  
Ajuste vertical

